

Instructions for Wall Ceiling Bullet and Fixed Dome Bracket Installation

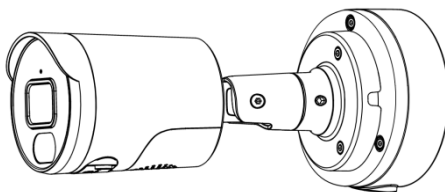

P/N: RVIMOCXHN0RA

Box Dimensions

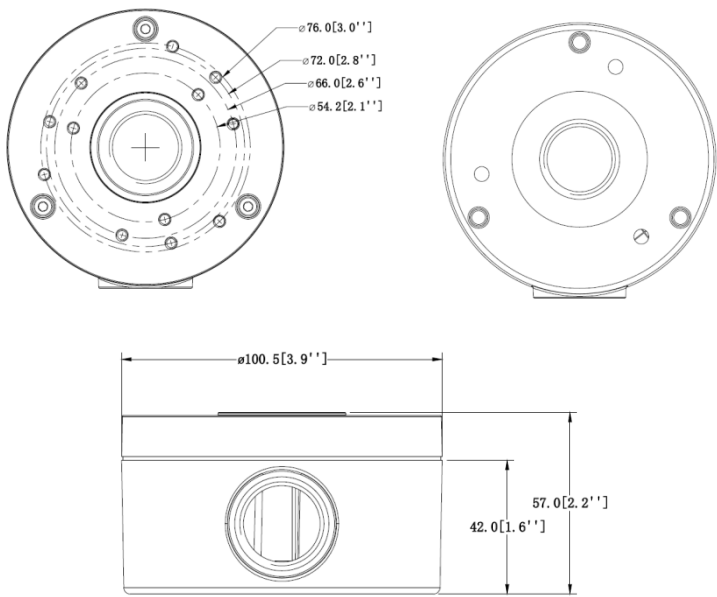

Accessories

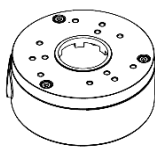

RVIM0CXHN0RA

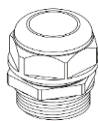

Waterproof Plug

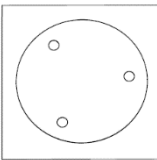

Mounting Paper



Screw A



Screw B



Screw C

Tools

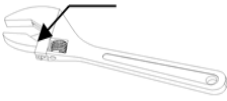

Monkey Wrench



Hex Wrench

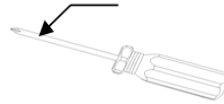

Cross Screwdriver

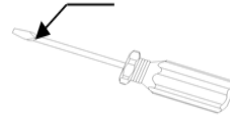

Straight Screwdriver

Wall Mounting

1. Paste the mounting paper to the corresponding installation position and make screw holes.
2. Hammer three screws **B** into the holes and lock the bottom cap of the junction box with screws **C** as shown below.

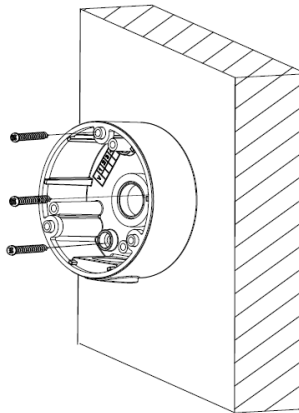

3. Thread the camera cable through the center of the top cover of the box and lock the camera base as shown below.

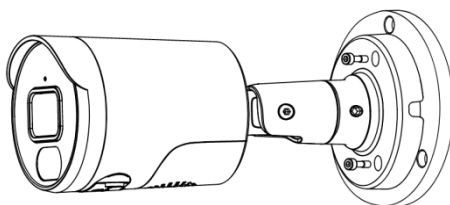

4. Connect the cable to the camera through the waterproof plug and tighten.
5. Lock the top cover to the bottom cap and adjust the camera angle to complete the installation.

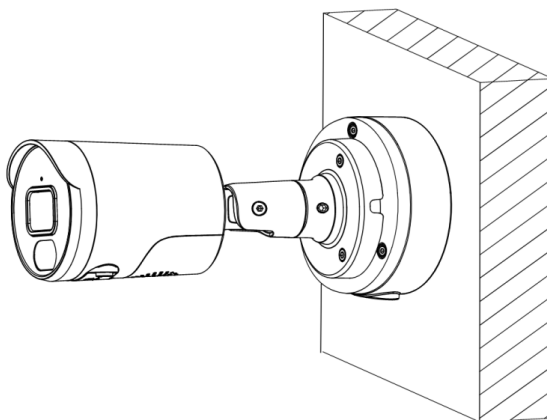

Supported Camera

P/N	Description
RVCM52A310RA	VUpoint 4MP Poe Bullet AI Camera
RVCM72A300RA	VUpoint 4MP Poe Eyeball AI Camera
RVCM52A350RA	VUpoint 5MP PoE VF Bullet AI Camera

